

# Shock Straw Instructions



Sometimes mistaken as unnecessary, shocking dental unit waterlines is a vital component of every effective waterline maintenance protocol. Shocking allows for low-level antimicrobial products like cartridges or straws to perform at their best. Follow these instructions to utilize the shock straw provided by ProEdge Dental Water Labs.

## When to Shock Your Dental Unit Waterlines:

- > Before first beginning a treatment protocol or when changing treatment products
- > At least every quarter (90 days)
- > When your waterline test reveals a contamination level of 200 CFU/mL or more

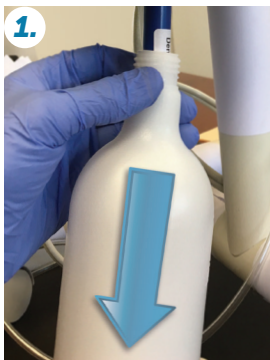

**1.** Remove your water bottle.

**2.** Unscrew your cartridge/straw from the quick-connect fitting.

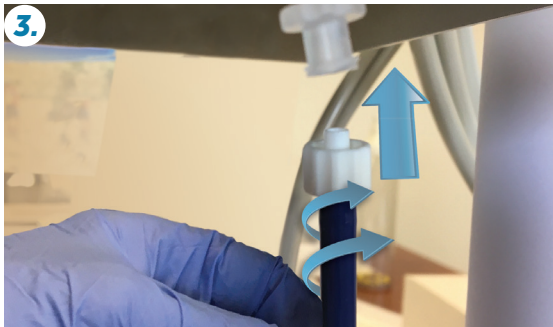

**3.** Attach ProEdge shock straw by simply twisting the male quick-connect fitting into the female fitting (about 1/2 turn is all it takes). Trim the length with scissors if necessary.

Complete shocking procedure. See *instructions for shocking with sodium hypochlorite (bleach) solution on the back of this page.*



**4.** After shocking, reattach your cartridge/straw and make a note of the install date.

# How to Shock Your Waterlines Using Diluted Bleach:

## STEP 1: CREATE BLEACH-WATER SOLUTION

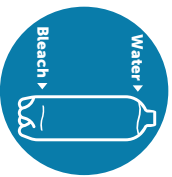

- > Detach your chair's water bottle.
- > Add a small amount of bleach based on your bottle size and bleach product concentration (See tables below). Fill the rest of the bottle with water.

8.25% Bleach Product Concentration:  
Add 1 part bleach for every 13 parts water

5.25% Bleach Product Concentration:  
Add 1 part bleach for every 9 parts water

## STEP 2: RE-ATTACH YOUR BOTTLE TO THE UNIT

## STEP 3: RUN BLEACH INTO EACH LINE



### Air-Water Syringe

- > Run each A/W Syringe for 10 seconds or until you smell the bleach flow out the spout or you notice the "slippery" feel of the bleach. The bleach is now in the lines.
- > Set your timer for 10 minutes.

### High & Slow Speed Lines

- > Remove each handpiece from the end of the line.
- > Place the handpiece connection into a sink, cup, or bucket.
- > Switch the "flush" toggle (or step on the reostat) for a few seconds until you can smell the bleach at the handpiece connection.
- > Repeat this procedure at every handpiece line, including slow speed handpieces.

- > If no water flows through your slow speed lines, shocking these lines is not necessary.



### Ultrasonic Scalers

- > If you have an ultrasonic scaler in this operator, run the scaler until you smell the bleach at the scaler tip.

## STEP 4: MONITOR YOUR TIMER



- > Leave bleach in each line for 10 minutes and NEVER MORE than 15 minutes.
- > After 10 minutes per line, disconnect the water bottles and dump the remaining solution into the sink. Do not send the bleach solution through evacuation lines.
- > Refill water bottles with warm water and flush the lines for 1-3 minutes or until the remaining bleach odor disappears.



## KNOW BEFORE YOUR SHOCK

- > **DO NOT** flush bleach into any vacuum or drain system that contains an amalgam separator.
- > **DO NOT** leave bleach or sodium hypochlorite in your waterlines for more than 10 minutes.
- > **DO** wear gloves and protective eye-wear.

## WHEN SHOULD I SHOCK?

- > Before first beginning a treatment protocol or when changing treatment products.
- > At least every quarter (90 days).
- > When your waterline test reveals a contamination level of 200 CFU/mL or more.

## WHY DO I NEED TO SHOCK?

Our lab continues to discover just how important this part of the treatment process is to ensuring your lines are clean and safe. Biofilm works hard to survive and spread. Periodically, a more powerful chemical agent is necessary to clear your line of any remaining bacteria to ensure any treatment product can be effective. Practices that shock early and often routinely receive passing water tests.

## IS BLEACH SAFE FOR EQUIPMENT?

Several manufacturers (including Midmark, DCI International, DentalEZ, DENTSPLY Cavtron, and Proma) have authorized weekly or daily water system treatment with a solution of bleach. Sterilex ULTRA® is an effective alternative, but will require leaving it in your waterlines overnight.

## Questions?

Call our team at 888.843.3343  
or visit [ProEdgeDental.com](http://ProEdgeDental.com)